

# miner

## LIP SHROUDS FOR EXCAVATORS AND LOADERS

GAMA COMPLETA  
PROTECTORES DE CUCHILLA

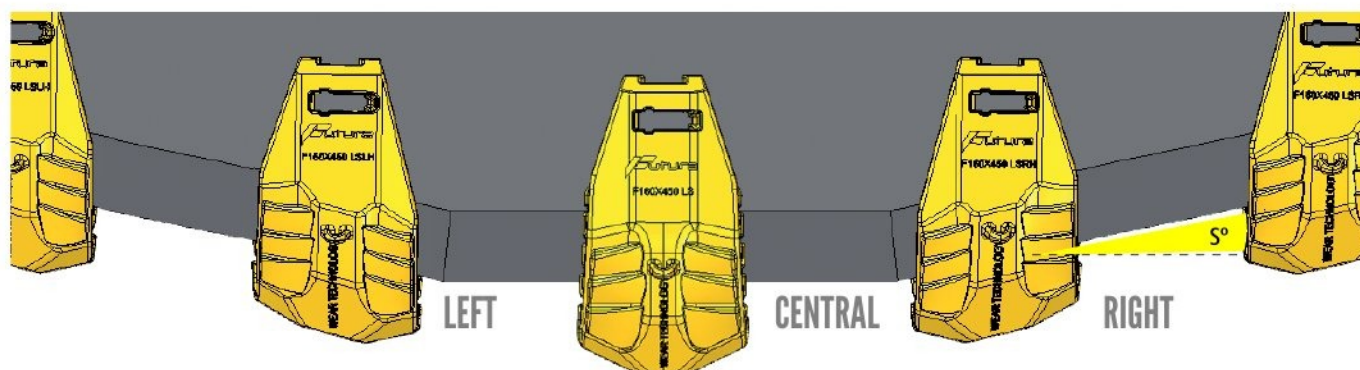

### ASSEMBLY MONTAJE

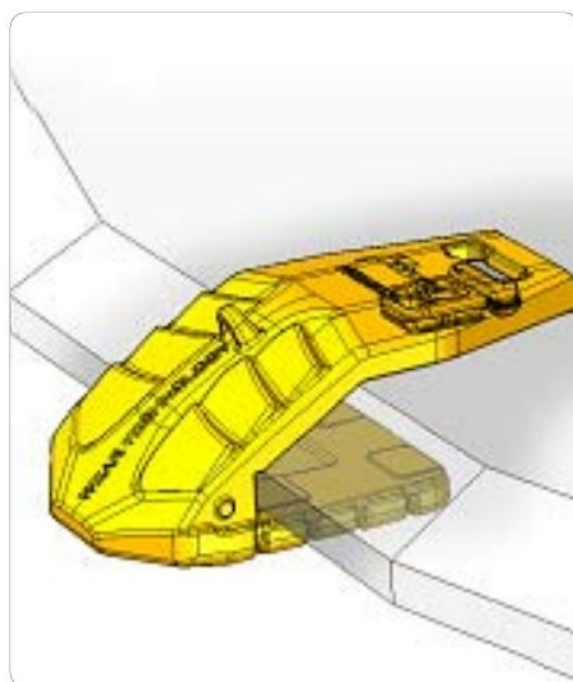
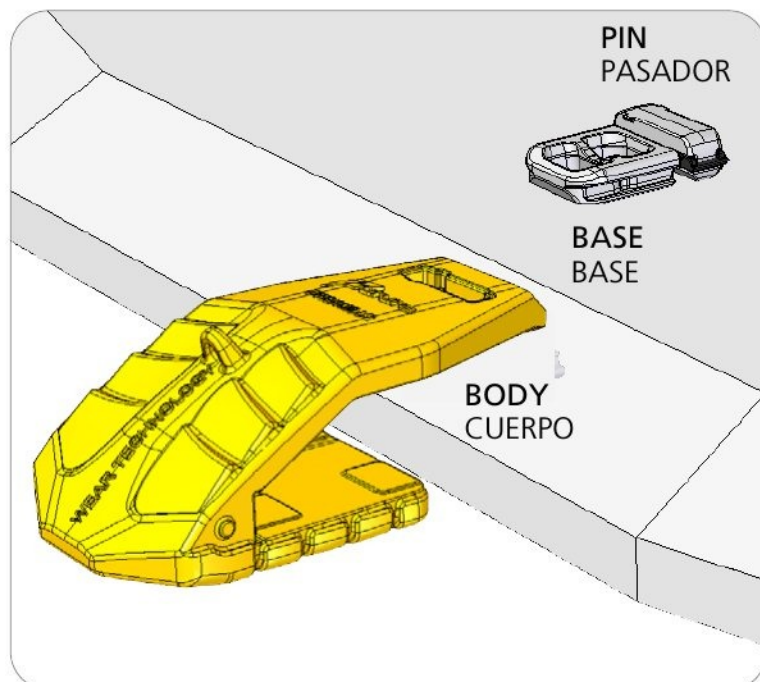

# EXCAVATOR Lip Shrouds Protector de Cuchilla para EXCAVADORA

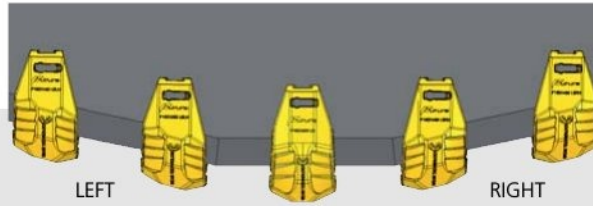
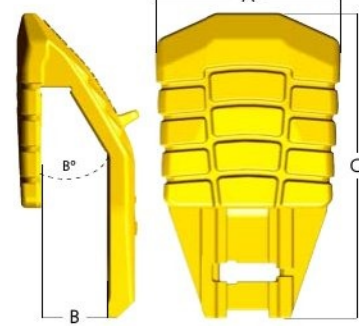
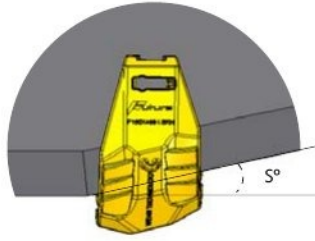

mm.		in		B°	S°	Kg		Lb		LEFT	RIGHT	BASE PIN	THRUST BLOCK
A	B	C											
240	72	429	16,9"	30°	14°	70	42	85	91	<b>F70X240 LSLH</b> TAC70X240-2L	<b>F70X240 LS</b> TAC70X240-1B	<b>F70X240 LSRH</b> TAC70X240-2R	FAB FAP
245	94	494	18,4"	30°	22°	90	46	99	101	<b>F90X245 LSLH</b> TAC 90X245-2LA	<b>F90X245 LS</b> TAC 90X245-1A	<b>F90X245 LSRH</b> TAC 90X245-2RA	FAB FAP
320	94	521	19,9"	30°	14°	90	80	169	175	<b>F90X320 LSLH</b> TAC 90X320-6L	<b>F90X320 LS</b> TAC 90X320-5 F90X360 LS	<b>F90X320 LSRH</b> TAC 90X320-6R	FAB FAP
360	94	527	20,7"	30°	14°	90	85	187	187	<b>F90X360 LSLH</b> TAC90X360-2L	<b>F90X360 LSRH</b> TAC90X360-2R	FAB FAP	
393	94	527	20,7"	30°	14°	90	88	195	195	<b>F90X390 LSLH</b> TAC90X390-1L	<b>F90X390 LSRH</b> TAC90X390-1R	FAB FAP	
290	103	629	23,7"	30°	22°	100	90	198	198	<b>F100X290 LSLH</b> TBC 100X290-4L	<b>F100X290 LS</b> TBC 100X290-3	<b>F100X290 LSRH</b> TBC 100X290-4R	FBB FBP
320	103	607	23,4"	30°	10°	100	100	218	219	<b>F100X320 LSLH</b> TBC 100X320-2L	<b>F100X320 LS</b> TBC 100X320-1B	<b>F100X320 LSRH</b> TBC 100X320-2R	FBB FBP
377	103	630	22,7"	30°	22°	100	114	251	251	<b>F100X375 LSLH</b> TBC100X375-1L	<b>F100X375 LS</b> TBC100X375-2	<b>F100X375 LSRH</b> TBC100X375-1R	FBB FBP
410	103	618	22,7"	30°	14°	100	112	247	247	<b>F100X375D14 LSLH</b> TBC100X375-3L	<b>F100X410 LS</b>	<b>F100X375D14 LSRH</b> TBC100X375-3R	FBB FBP
410	103	618	23,6"	30°	10°	100	126	278	278	<b>F100X410 LSLH</b> TBC 100X410-4L	<b>F100X410 LS</b> TBC 100X410-3	<b>F100X410 LSRH</b> TBC 100X410-4R	FBB FBP
430	103	629	24,8"	30°	22°	100	133	293	293	<b>F100X430 LSLH</b> TBC 100X430-2L	<b>F100X430 LS</b> TBC100X430-1	<b>F100X430 LSRH</b> TBC 100X430-2R	FBB FBP
330	124	639	24,0"	30°	-	120	118	260	265	<b>F120X330 LSLH</b> TBC 120X330-2LA	<b>F120X330 LS</b> TBC120X330-1A	<b>F120X330 LSRH</b> TBC 120X330-2RA	FBB FBP
375	124	641	24,5"	30°	22°	120	140	309	309	<b>F120X375 LSLH</b>	<b>F120X375 LS</b>	<b>F120X375 LSRH</b>	FBB FBP
410	124	626	24,8"	30°	14°	120	150	331	338	<b>F120X410 LSLH</b> TBC120X410-3L	<b>F120X410 LS</b>	<b>F120X410 LSRH</b> TBC120X410-3R	FBB FBP
410	124	626	25,2"	30°	22°	120	154	338	338	<b>F120X410D22 LSLH</b> TBC120X410-2L	<b>F120X410D22 LSRH</b> TBC120X410-2R	FBB FBP	

# EXCAVATOR Lip Shrouds Protector de Cuchilla para EXCAVADORA

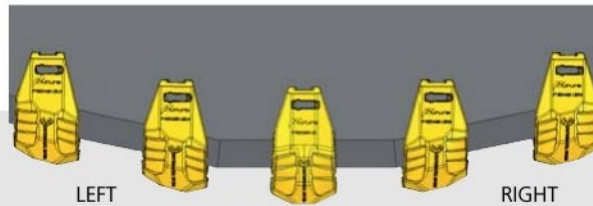
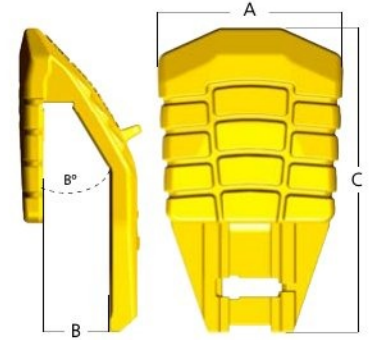

mm.		in		B°	S°	kg	Lb						
A	B	C						LEFT	RIGHT	BASE PIN	THRUST BLOCK		
440	124	608	24,5"	30°	11,5°	120	287	<b>F120X440 LSLH</b> TBC120X440-2LB	<b>F120X440 LS</b> TBC120X440-1B	<b>F120X440 LSRH</b> TBC120X440-2RB	FBB FBP		
535	124	610	24,0"	30°	11,5°	120	367	<b>F120X535 LSLH</b> TBC120X535-4L	<b>F120X535 LS</b> TBC120X535-3	<b>F120X535 LSRH</b> TBC120X535-4R	FBB FBP		
420	143	729	28,1"	30°	11,5°	140	397	<b>F140X420 LSLH</b> TBC140X420-2LA	<b>F140X420 LS</b> TBC140X420-1A	<b>F140X420 LSRH</b> TBC140X420-2RA	FBB FBP	TB160140	
465	143	730	28,1"	30°	11,5°	140	487	<b>F140X465 LSLH</b> TBC140X465-1RB	<b>F140X465 LS</b> TBC140X465-3A	<b>F140X465 LSRH</b> TBC140X465-1RB	FBB FBP		
490	143	730	28,1"	30°	11,5°	140	507	<b>F140X490 LSLH</b> TBC140X490-2LB	<b>F140X490 LS</b> TBC140X490-1B	<b>F140X490 LSRH</b> TBC140X490-2RB	FBB FBP		
575	143	768	30,2"	30°	11,5°	140	509	<b>F140X575 LSLH</b> TBC140X575-1LA	<b>F140X575 LS</b> F140X575 LS	<b>F140X575 LSRH</b> TBC140X575-1RA	FBB FBP	TB140	
430	166	727	28,6"	30°		160	403		<b>F160X430 LS</b> TBC160X430-1		FBB FBP		
450	166	800	32,3"	30°	14°	160	538	<b>F160X450 LSLH</b> TBC160X450-2L	<b>F160X450 LS</b> TBC160X450-1	<b>F160X450 LSRH</b> TBC160X450-2R	FBB FBP	TB160140	
520	166	824	32,4"	30°	14°	160	703	<b>F160X520 LSLH</b> TBC160X520-1L		<b>F160X520 LSRH</b> TBC160X520-1R	FBB FBP		
570	166	854	33,6"	30°	14°	160	780	<b>F160X570 LSLH</b> TBC160X570-1L		<b>F160X570 LSRH</b> TBC160X570-1R	FBB FBP		
430	234	822	32,4"	30°		230	853		<b>F230X430 LS</b> TCCF130-28 TCCF130-21C TCCF130-21D		FCB FCP	TB230	
600	234	868	34,2"	30°		230	1.003		<b>F230X600 LS</b> TCCF130-16A TCC130-25C		FCB FCP		
410	250	879	34,6"	30°		245	763		<b>F245X410 LS</b> TCCF145-4 TCCF145-5 TCCF145-1B		FCB FCP		
570	250	879	34,6"	30°		245	1.041		<b>F245X570 LS</b> TCCF145-3 TCCF145-6 TCCF145-8 TCCF145-2B		FCB FCP		

## LOADER Lip Shrouds Protector de Cuchilla para CARGADORA

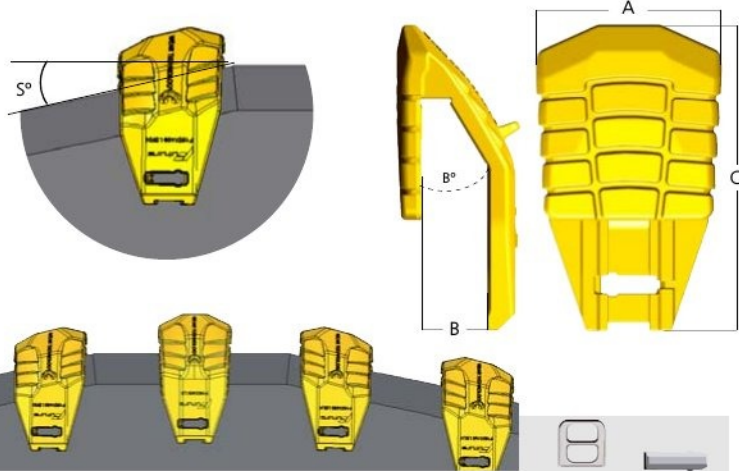

mm.		in.		B°	S°	KG	Lb	LEFT	CENTER	RIGHT	BASE	PIN
A	B	C										
345	52	429	16,9"	-	-	72	158	<b>F50X345 LDSLH</b> TAC50X345-4L	<b>F50X345 LDS</b> TAC50X345-3	<b>F50X345 LDSRH</b> TAC50X345-4R	FAB	FAP
13,6"	2,0"	445	17,5"	30°	13°	50	105					
					2"							
415	73	468	18,4"	-	-	100	220	<b>F70X415 LDSLH</b> TAC70X415-3L	<b>F70X415 LDS</b> TAC70X415-1	<b>F70X415 LDSRH</b> TAC70X415-3R	FAB	FAP
16,3"	2,9"	494	19,4"	30°	13°	70	105					
					2,8"							
450	73	563	22,2"	-	-	105	231	<b>F70X450 LDSLH</b> TAC70X450-2LA	<b>F70X450 LDS</b> TAC70X450-1A	<b>F70X450 LDSRH</b> TAC70X450-2RA	FAB	FAP
17,7"	2,9"	572	22,5"	30°	10°	70	107					
					2,8"							
430	77	575	22,6"	-	-	153	337	<b>F75X430 LDSLH</b> TAC75X430-2L	<b>F75X430 LDS</b> TAC75X430-1	<b>F75X430 LDSRH</b> TAC75X430-2R	FAB	FAP
16,9"	3,0"	600	23,6"	30°	13°	75	154					
					3"							
435	94	610	24,0"	-	-	159	351	<b>F90X435 LDSLH</b> TBC90X435-2LC	<b>F90X435 LDS</b> TBC90X435-1	<b>F90X435 LDSRH</b> TBC90X435-2RC	FBB	FBP
17,1"	3,7"	635	25,0"	30°	10°	90	163					
					3,5"							
410	103	615	24,2"	-	-	135	298	<b>F100X410 LDSLH</b> TBC100X410-2LB	<b>F100X410 LDS</b> TBC100X410-1B	<b>F100X410 LDSRH</b> TBC100X410-2RB	FBB	FBP
16,1"	4,1"	635	25,0"	30°	10°	100	138					
					3,9"							
410	103	756	29,8"	-	-	203	448	<b>F100X410B22 LDSLH</b> TBC100X410-6LA	<b>F100X410B22 LDS</b> BC100X410-5A	<b>F100X410B22 LDSRH</b> TBC100X410-6RA	FBB	FBP
16,1"		763	30,0"	22°	15°	100	208					
					3,9"		459					

## LOADER Lip Shrouds Protector de Cuchilla SOLDABLE para CARGADORA

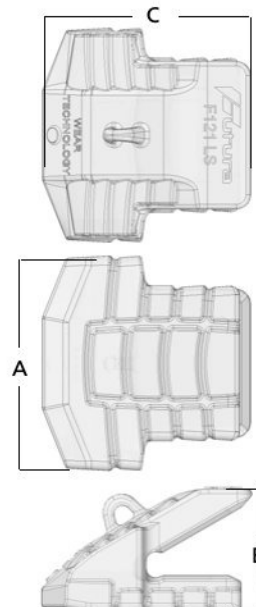

mm.		in.		KG	Lb	REF	OEM
A	B	C					
360	209	355	87,00	120		<b>F121 LS</b>	WS141LL
14,17"	8,23"	13,98"	191,80	4,72"			

## OPTIONAL Thrust Blocks Piezas de Apoyo OPCIONALES

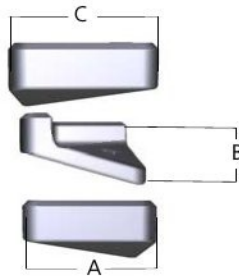

mm.				REF	LIP SHROUD	UNITS
A	B	C				
190	106	190	11,70	<b>TB140</b>	F140X475 RH/LH	1
7,48"	4,17"	7,48"	25,79			

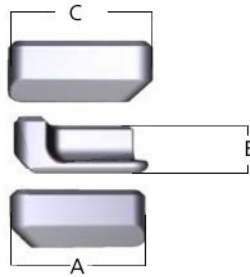

mm.				REF	LIP SHROUD	UNITS
A	B	C				
190	79	190	11,00	<b>TB160140</b>	F140X420 LS/RH/LH F160X450 LS/RH/LH	1
7,48"	3,11"	7,48"	24,25			

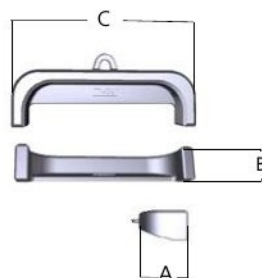

mm.				REF	LIP SHROUD	UNITS
A	B	C				
170	104	550	22,00	<b>TB230</b>	F230X430 LS	1
6,69"	4,09"	21,65"	48,50			



## TOP Wing Shrouds Protector Lateral Superior de Cazo

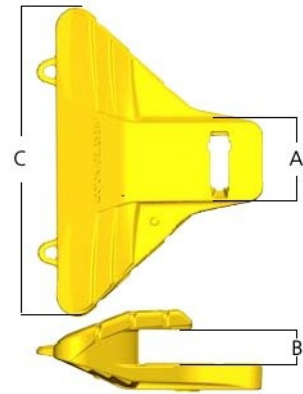

mm.				BASE	PIN	PIN&WAS	THRUST BLOCK				
A	B	C		REF	Cross Ref					Cross Ref	
175 6,89"	42 1,65"	440 17,32"	26,50 58,42	<b>F40X440 UWS</b>	TAW40X440-1A	FAB	FAP	-	<b>FDD33095 TB</b>	PDD33095#1	
175 6,89"	42 1,65"	560 22,05"	53,40 117,72	<b>F40X560 UWS</b>	TAW40X560-1	FAB	FAP	-	<b>FDD33096 TB</b>	PDD33096#1	<b>40</b> 1,57"
171 6,73"	42 1,65"	600 23,62"	33,50 73,85	<b>F40X600 UWS</b>	TAW40X600-1	FAB	FAP	BE7-5280 75KLSR	<b>FDE51413 TB</b>	PDE51413#3	
175 6,89"	53 2,09"	505 19,88"	49,60 109,35	<b>F50X505 UWS</b>	TAW50X505-2	FAB	FAP	-	<b>FDD32816 TB</b>	PDD32816#1	
176 6,93"	53 2,09"	505 19,88"	31,50 69,44	<b>F50X505B UWS</b>	TAW50X505-1A	FAB	FAP	-	<b>FDD32816 TB</b>	PDD32816#1	
175 6,89"	53 2,09"	630 24,80"	49,40 108,91	<b>F50X630 UWS</b>	TAW50X630-1A	FAB	FAP	-	<b>FDE51413 TB</b>	PDE51413#3	<b>50</b> 1,97"
175 6,89"	53 2,09"	655 25,79"	86,50 190,70	<b>F50X655 UWS</b>	TBW50X655-1	FAB	FAP	-	<b>FDD33097 TB</b>	PDD33097#1	
228 8,98"	53 2,09"	800 31,50"	74,20 163,58	<b>F50X800 UWS</b>	TAW50X800-1A	FAB	FAP	?	<b>F3489 TB</b>	EP3489#1	
228 8,98"	67 2,64"	800 31,50"	83,00 182,98	<b>F65X800 UWS</b>	TAW65X800-1B	FAB	FAP	?	<b>F3489 TB</b>	EP3489#1	<b>65</b> 2,56"
217 8,54"	77 3,03"	545 21,46"	52,00 114,64	<b>F75X545 UWS</b>	TBW75X545-1A	FBB	FBP	-	<b>FDE1987 TBLH</b>	PDE51987#2L	<b>75</b> 2,95"
220 8,66"	78 3,07"	655 25,79"	99,00 218,25	<b>F75X655 UWS</b>	TBW75X655-1	FBB	FBP	-	<b>FDE1987 TBRH</b>	PDE51987#2R	
226 8,90"	82 3,23"	797 31,38"	111,00 244,71	<b>F80X800 UWS</b>	TBW80X800-1A	FBB	FBP	?	<b>F3492 TB</b>	EP3492#1	<b>80</b> 3,15"
226 8,90"	93 3,66"	495 19,49"	67,00 147,71	<b>F90X495 UWS</b>	TBW90X495-1	FBB	FBP	-			<b>90</b> 3,54"
226 8,90"	93 3,66"	855 33,66"	235,00 518,08	<b>F90X855 UWS</b>	TBW90X855-1A	FBB	FBP	-	<b>FDD32678 TB</b>	PDD32678#1	
220 8,66"	103 4,06"	965 37,99"	158,80 350,09	<b>F100X965 UWS</b>	TBW100X965-1	FBB	FBP	-	<b>FDD32680 TB</b>	PDD32680#1	<b>100</b> 3,94"
202 7,95"	123 4,84"	760 29,92"	165,00 363,76	<b>F120X760 UWS</b>	TAW120X760-1	FAB	FAP	-	<b>FDD33024 TB</b>	PDD33024#1	<b>120</b> 4,72"
250 9,84"	123 4,84"	760 29,92"	194,00 427,69	<b>F120X760A UWS</b>	TAW120X760-1A	FBB	FBP	-	<b>F3495 TB</b>	EP3495#1	
253 9,96"	142 5,59"	800 31,50"	238,00 524,69	<b>F140X800 UWS</b>	TBW140X800-1	FBB	FBP	-	<b>FDD33366 TB</b>	PDD33366#1	<b>140</b> 5,51"

### ASSEMBLY MONTAJE

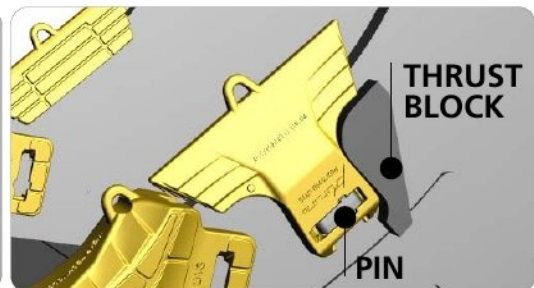
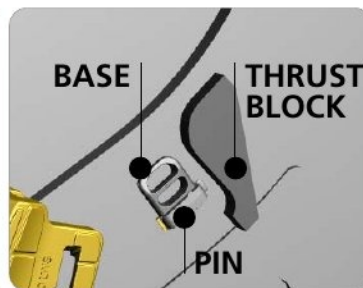

## Bolt-On Wing Shrouds Protector Lateral Atornillable



mm.				REF	Cross Ref	BASE	PIN	PIN	WASHER	THRUST BLOCK			
A	B	C	KG										
268 10,55"	42 1,65"	600 23,62"	33,50 73,85	<b>F40X600 UWS</b>	TAW40X600-1	FAB	FAP	BE7-5280	2 Un.	75KLKSR	4 Un.	FDE1413 TB PDE51413#3	<b>40</b> 1,57"
359 14,13"	53 2,09"	800 31,50"	74,20 163,58	<b>F50X800 UWS</b>	TAW50X800-1A				2 Un.		4 Un.	F3489 TB EP3489#1	<b>50</b> 1,97"
358 14,09"	53 2,09"	800 31,50"	59,90 132,05	<b>FES4410</b>	ES4410	FAB	FAP	E7-4411-4A	2 Un.	75KLKSR	4 Un.	FDD32816 TB PDD32816 TB#1	<b>50</b> 1,97"
360 14,17"	67 2,64"	800 31,50"	83,00 182,98	<b>F65X800 UWS</b>	TAW65X800-1B	FAB	FAP		2 Un.		4 Un.	F3489 TB EP3489#1	<b>65</b> 2,56"
356 14,02"	82 3,23"	800 31,50"	111,00 244,71	<b>F80X800 UWS</b>	TBW80X800-1A	FAB	FAP		2 Un.		4 Un.	F3492 TB EP3492#1	<b>80</b> 3,15"

### Two Locking Options Dos opciones de montaje:

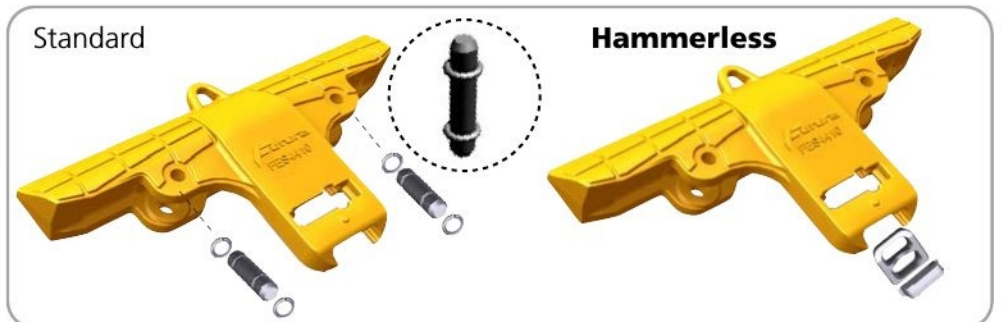

## LOWER Wing Shrouds Protector Lateral Inferior



mm.			REF	Cross Ref	BASE	PIN	THRUST BLOCK	Cross Ref		
A	B	C								
309 12,17"	53 2,09"	185 7,28"	69,00 152,12	<b>F50 LWS</b>	TAW50-1	FAB	FAP	-	-	<b>50</b> 1,97"
295 11,61"	66 2,60"	219 8,62"	75,70 166,89	<b>F65 LWS</b>	TAW65-1	FAB	FAP	<b>FDD33808 TB</b>	PDD33808	<b>65</b> 2,56"
301 11,85"	77 3,03"	261 10,28"	81,50 179,67	<b>F75 LWS</b>	TAW75-1	FAB	FAP	<b>FDD33808 TB</b>	PDD33808	<b>75</b> 2,95"
307 12,09"	93 3,66"	259 10,20"	85,00 187,39	<b>F90 LWS</b>	TAW90-1	FAB	FAP	<b>FDD33808 TB</b>	PDD33808	<b>90</b> 3,54"
291 11,46"	116 4,57"	286 11,26"	91,00 200,62	<b>F115 LWS</b>	TAW115-1	FAB	FAP	<b>FDD33312 TB</b>	PDD33312#1	<b>115</b> 4,53"
317 12,48"	138 5,43"	399 15,71"	113,00 249,12	<b>F135 LWS</b>	TAW135-1	FAB	FAP	<b>FDD33312 TB</b>	PDD33312#1	<b>135</b> 5,31"
350 13,78"	165 6,50"	365 14,37"	194,00 427,69	<b>F165 LWS-RH</b>	TBW165-1R	FBB	FBP	<b>FDD33367 TB</b>	PDD33367#1	<b>165</b> 6,50"
350 13,78"	165 6,50"	365 14,37"	194,00 427,69	<b>F165 LWS-LH</b>	TBW165-1L					

### ASSEMBLY MONTAJE

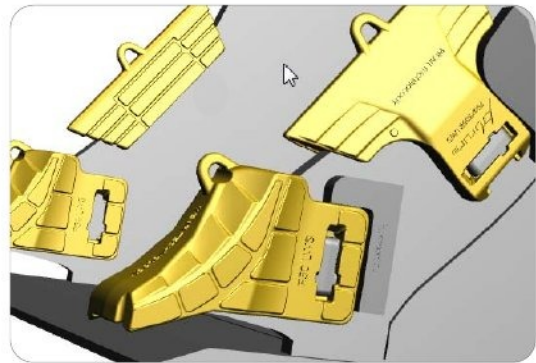
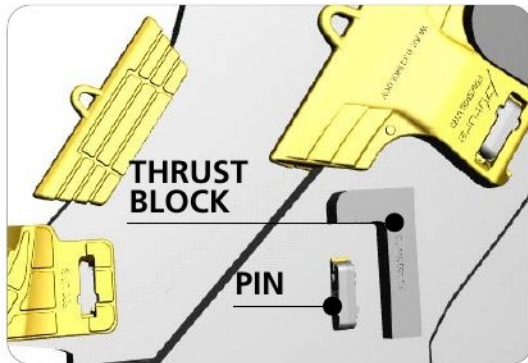



## Wing Shroud Protector Lateral de Cazo

### Two Locking Options

Dos opciones de montaje

### Hammerless

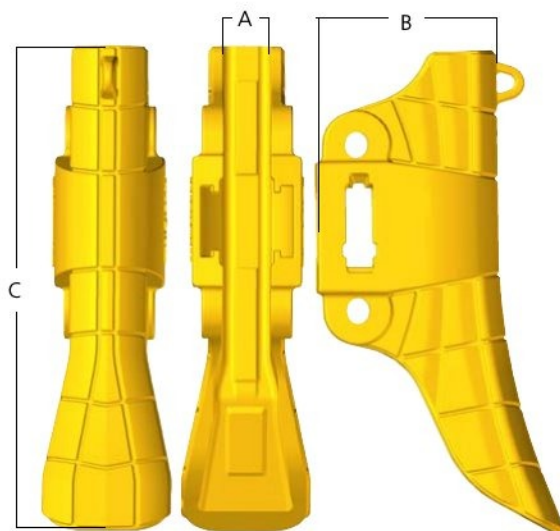
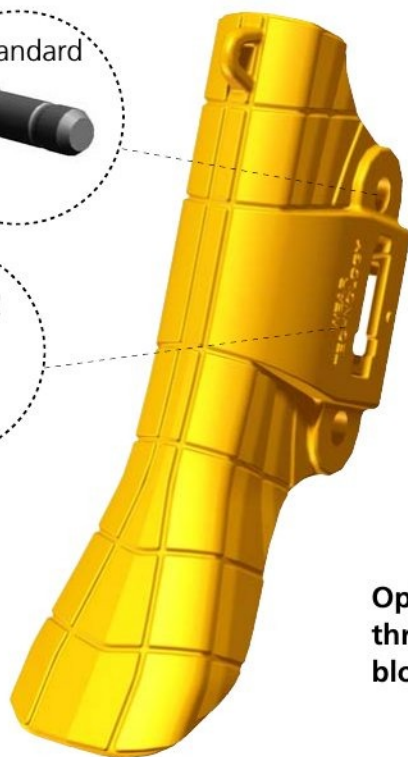

### Optional thrust blocks

Bloqueo opcional



mm.				BASE	PIN	PIN	WASHER	THRUST BLOCK					
A	B	C	KG	REF	Cross Ref								
83	333	884	132,40	<b>FPDE52445</b>	PDE52445	FBB	PBP	PDB31183-3	2 Un.	120KLKSR	2 Un.	FDE52445 TB	<b>80</b>
3,27"	13,11"	34,80"	291,89									PDE52445	3,15"

## Wing Shroud Compatible O&K Protector Lateral para Cazo O&K

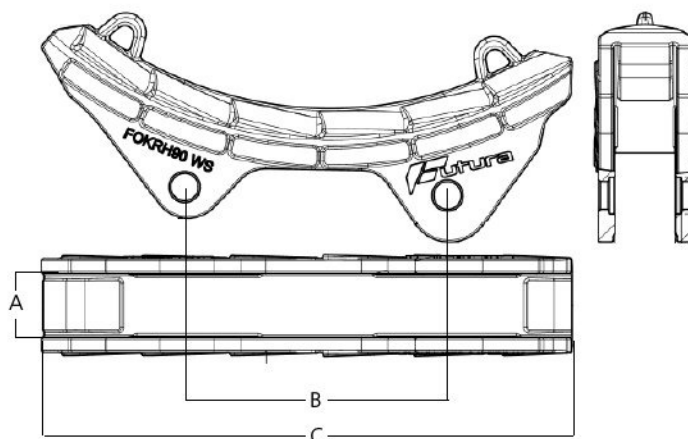

mm.				PIN	WASHER	
A	B	C	KG	REF	Cross	
93	401	811	70,00	<b>FOKRH90 WS</b>	2224824	2 Un.
3,66"	15,79"	31,93"	154,32			2 Un.
						<b>90</b>
						3,54"

## Thrust Blocks for Top Wing Shrouds Bloques de Apoyo

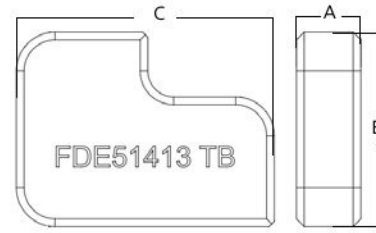



mm.				REF	Cross Ref	FOR SHROUD		REF	
A	B	C							
26 1,02"	92 3,61"	174 6,85"	1,90 4,19	<b>F3489 TB</b>	EP3489#1	F50X800 UWS F65X800 UWS	<b>50</b> <b>65</b>	1,97" 2,56"	
30 1,18"	125 4,92"	220 8,66"	3,40 7,50	<b>F3492 TB</b>	EP3492#1	F80X800 UWS	<b>80</b>	3,15"	
25 0,97"	153 6,01"	182 7,18"	3,10 6,83	<b>F3495 TB</b>	EP3495#1	F120X760A UWS	<b>120</b>	4,72"	
63 2,48"	121 4,76"	392 15,44"	19,00 41,89	<b>FDD32678 TB</b>	PDD32678#1	F90X855 UWS	<b>90</b>	3,54"	
40 1,57"	120 4,72"	217 8,52"	4,60 10,14	<b>FDD32680 TB</b>	PDD32680#1	F100X965 UWS	<b>100</b>	3,94"	
45 1,77"	121 4,76"	326 12,83"	8,20 18,08	<b>FDD32816 TB</b>	PDD32816#1	F50X505 UWS F50X505B UWS	<b>50</b>	1,97"	
40 1,57"	82 3,23"	252 9,92"	3,50 7,72	<b>FDD33024 TB</b>	PDD33024#1	F120X760 UWS	<b>120</b>	4,72"	
25 0,98"	48 1,89"	176 6,93"	1,60 3,53	<b>FDD33095 TB</b>	PDD33095#1	F40X440 UWS	<b>40</b>	1,57"	

## Thrust Blocks for Top Wing Shrouds Bloques de Apoyo

A	mm.			REF	Cross Ref	FOR SHROUD		REF	
	B	C							
26 1,02"	156 6,14"	194 7,64"	3,50 7,72	<b>FDD33096 TB</b>	PDD33096#1	F40X560 UWS	<b>40</b>	1,57"	
26 1,02"	20 0,79"	227 8,94"	2,70 5,95	<b>FDD33097 TB</b>	PDD33097#1	F50X655 UWS	<b>50</b>	1,97"	
45 1,77"	102 4,02"	178 7,00"	3,75 8,27	<b>FDD33312 TB</b>	PDD33312#1	F115 LWS	<b>115</b> <b>135</b>	4,53" 5,31"	
63 2,48"	190 7,48"	280 11,02"	11,60 25,57	<b>FDD33366 TB</b>	PDD33366#1	F140X800 UWS	<b>140</b>	5,51"	
63 2,48"	178 7,01"	255 10,03"	11,20 24,69	<b>FDD33367 TB</b>	PDD33367#1	F165 LWS-RH F165 LWS-LH	<b>165</b>	6,50"	
40 1,57"	137 5,39"	237 9,33"	5,12 11,29	<b>FDD33808 TB</b>	PDD33808	F65 LWS F75 LWS F90 LWS	<b>65</b> <b>75</b> <b>90</b>	2,56" 2,95" 3,54"	
25 0,98"	75 2,95"	100 3,94"	1,20 2,65	<b>FDE51413 TB</b>	PDE51413#3	F40X600 UWS F50X630 UWS	<b>40</b> <b>50</b>	1,57" 1,97"	
40 1,57"	102 4,02"	227 8,94"	4,24 9,35	<b>FDE51987 TBLH</b> <b>FDE51987 TBRH</b>	PDE51987#2L PDE51987#2R	F75X545 UWS	<b>75</b>	2,95"	
40 1,57"	69 2,72"	178 7,01"	3,58 7,89	<b>FDE52445 TB</b>	PDE52445 TB	FPDE52445	<b>80</b>	3,15"	

## Wing Shroud PIN Pasador



mm.			REF	Cross Ref Cruce Ref		Unit
C	∅					
112 4,41"	22 0,87"	0,31 0,68	<b>E7-4411-4A</b>	----	75KLKSR	2
80 3,15"	22 0,87"	0,22 0,49	<b>BE7-5280</b>	----	75KLKSR	2
164 6,45"	38 1,50"	1,38 3,04	<b>PDB31183-3</b>	----	120KLKSR	1

## Wing Shroud WASHER Arandela

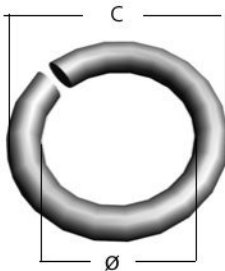

mm.			REF	Unit
C	∅			
32 1,26"	19,5 0,77"	0,02 0,00"	<b>75KLKSR</b>	2
51 2,01"	35 1,38"	0,05 0,00"	<b>120KLKSR</b>	1

## Lip Shroud **BASE** BASE para Protector de Cuchilla

mm.				REF	Cross Ref
A	B	C			
86 3,39"	32 1,26"	90 3,54"	0,80 1,76	<b>FAB</b>	TAB
127 5,00"	38 1,49"	128 5,04"	1,85 4,08	<b>FBB</b>	TBB
160 6,30"	47,5 1,87"	166 6,55"	3,85 8,49	<b>FCB</b>	TCB

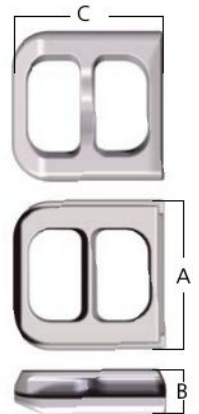

## Lip Shroud **PIN** PASADOR para Protector de Cuchilla

mm.				REF	Cross Ref
A	B	C			
31 1,22"	40 1,57"	127 5,00"	0,85 1,87	<b>FAP</b>	TAP
45 1,77"	52 2,05"	162 6,38"	2,10 4,63	<b>FBP</b>	TBP
50 1,97"	64 2,52"	216 8,50"	REF! REF!	<b>FCP</b>	TCP

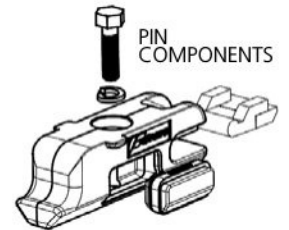
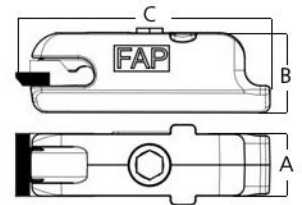

## EXTFLS Pin Extration **TOOL** HERRAMIENTA Extractora

**PIN  
EXTRACTOR  
FOR WING  
SHROUDS**

**EXTRACTOR  
PARA  
PROTEC-  
TORES  
LATERA-  
LES**

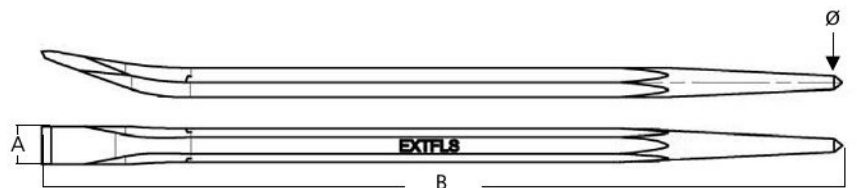
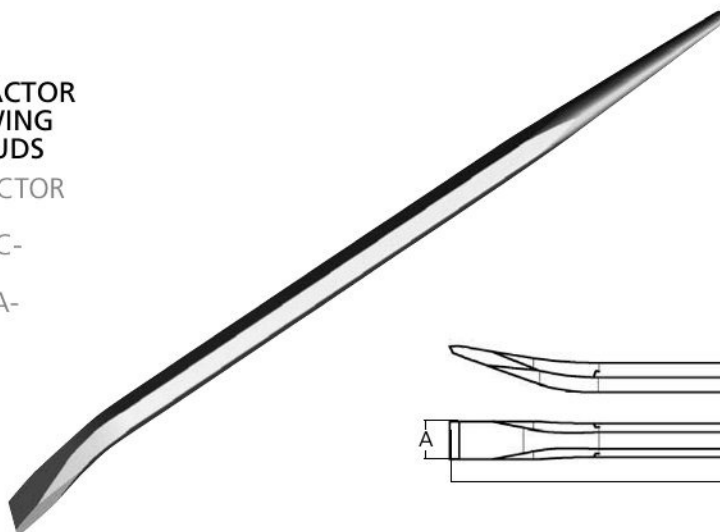

mm.				
A	B	Ø		REF
16,4 0,65"	350,0 13,78"	5,8 0,23"	0,3 0,66	<b>EXTFLS</b>



# LHD

# miner



## 20 mm.

THE 20 mm. PISTON EXPANSION ALLOWS TO MAINTAIN TENSION OF THE SHROUD AGAINST THE BLADE THROUGH OUT THE SHROUD WEAR LIFE



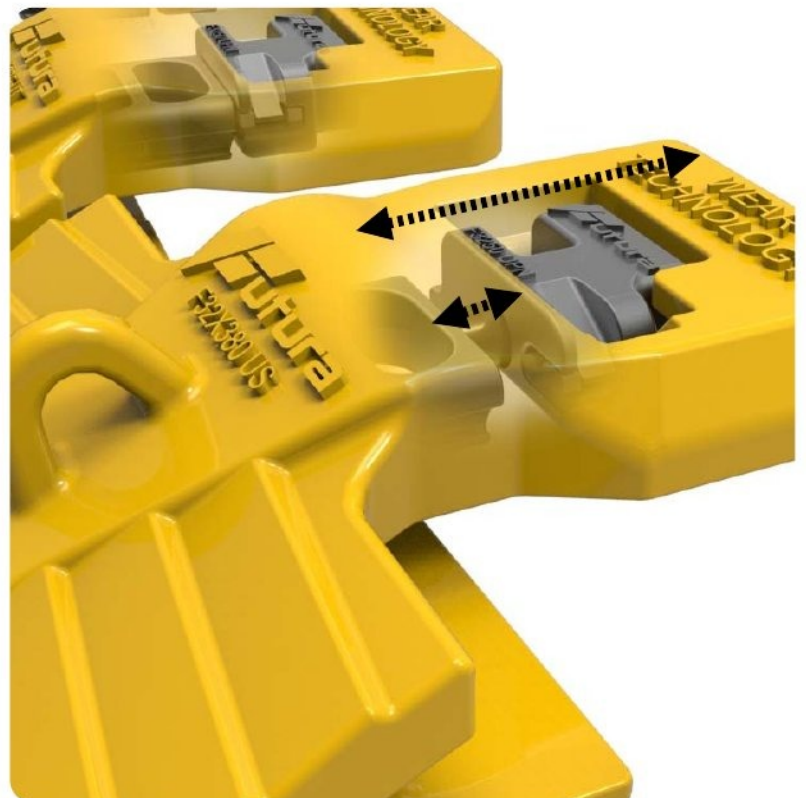





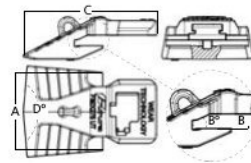
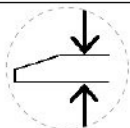

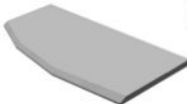

LOS 20mm. DE EXPANSIÓN DEL PISTÓN DEL PASADOR PERMITEN MANTENER LA TENSION DEL PASADOR CONTRA EL PROTECTOR DURANTE TODA SU VIDA ÚTIL.



LHD MINER

32MM



<b>SPADE BLADE</b> CUCHILLA DELTA		<b>SPADE BLADE</b> CUCHILLA DELTA		
<b>CAST CORNERS</b> CANTONERA SOLDABLE		<b>CAST CORNER RIGHT</b> CANTONERA SOLDABLE <b>F32X155 UCCR</b> ALTERNATIVE TO 69039974, SCC32X155-RS	Kg. 36,3 lb 79,86 A 171 6,73" B 32 1,26" C 250 9,84"	
<b>CAST CORNERS</b> CANTONERA SOLDABLE		<b>CAST CORNER LEFT</b> CANTONERA SOLDABLE <b>F32X155 UCCL</b> ALTERNATIVE TO 69039973, SCC32X155-LS	Kg. 36,3 lb 79,86 A 171 6,73" B 32 1,26" C 250 9,84"	
<b>CORNER SHROUD</b> PROTECTOR ESQUINA		<b>CORNER SHROUD RIGHT</b> PROTECTOR ESQUINA DERECHO <b>F32X210 UCR</b> ALTERNATIVE TO 69039972, SBP32X210-CR2	Kg. 41,4 lb 91,08 A 243 9,57" B 18 0,71" C 475 18,70"	BASE <b>FAB</b> <b>FUAB</b> PIN <b>F3250 UPN</b> EXT. <b>EXTFU</b>
<b>CORNER SHROUD</b> PROTECTOR ESQUINA		<b>CORNER SHROUD LEFT</b> PROTECTOR ESQUINA IZQUIERDO <b>F32X210 UCL</b> ALTERNATIVE TO 69039971, SBP32X210-CL2	Kg. 41,4 lb 91,08 A 243 9,57" B 18 0,71" C 472 18,58"	BASE <b>FAB</b> <b>FUAB</b> PIN <b>F3250 UPN</b> EXT. <b>EXTFU</b>
<b>CORNER SHROUD</b> PROTECTOR ESQUINA		<b>3/4 CORNER SHROUD RIGHT</b> PROTECTOR ESQUINA 3/4 DCHO. <b>F32X210 UCRH</b> ALTERNATIVE TO 69042489, SBP32X210-CRH2	Kg. 32,9 lb 72,38 A 243 9,57" B 18 0,71" C 432 17,01"	BASE <b>FAB</b> <b>FUAB</b> PIN <b>F3250 UPN</b> EXT. <b>EXTFU</b>
<b>CORNER SHROUD</b> PROTECTOR ESQUINA		<b>3/4 CORNER SHROUD LEFT</b> PROTECTOR ESQUINA <b>F32X210 UCLH</b> ALTERNATIVE TO 69042488, SBP32X210-CLH2	Kg. 32,9 lb 72,38 A 243 9,57" B 18 0,71" C 432 17,01"	BASE <b>FAB</b> <b>FUAB</b> PIN <b>F3250 UPN</b> EXT. <b>EXTFU</b>
<b>TRANSITION SHROUD</b> PROTECTOR TRANSICIÓN		<b>TRANSITION SHROUD</b> PROTECTOR TRANSICIÓN <b>F32X275 UT</b> ALTERNATIVE TO 69039970, SBP32X275-T2	Kg. 38,5 lb 84,7 A 275 10,83" B 33,5 1,32" C 444 17,48"	BASE <b>FAB</b> <b>FUAB</b> PIN <b>F3250 UPN</b> EXT. <b>EXTFU</b>
<b>STRAIGHT SHROUD</b> PROTECTOR RECTO		<b>STRAIGHT SHROUD 250</b> PROTECTOR RECTO <b>F32X250 US</b> ALTERNATIVE TO 69039967, SBP32X250-S2	Kg. 34,8 lb 76,56 A 250 9,84" B 33,5 1,32" C 434 17,09"	BASE <b>FAB</b> <b>FUAB</b> PIN <b>F3250 UPN</b> EXT. <b>EXTFU</b>
<b>STRAIGHT SHROUD</b> PROTECTOR RECTO		<b>STRAIGHT SHROUD 310</b> PROTECTOR RECTO <b>F32X310 US</b> ALTERNATIVE TO 69039968, SBP32X310-S2	Kg. 41,1 lb 90,42 A 310 12,20" B 33,5 1,32" C 434 17,09"	BASE <b>FAB</b> <b>FUAB</b> PIN <b>F3250 UPN</b> EXT. <b>EXTFU</b>
<b>STRAIGHT SHROUD</b> PROTECTOR RECTO		<b>STRAIGHT SHROUD 380</b> PROTECTOR RECTO <b>F32X380 US</b> ALTERNATIVE TO 69039969, SBP32X380-S2	Kg. 47,9 lb 105,38 A 380 14,96" B 33,5 1,32" C 434 17,09"	BASE <b>FAB</b> <b>FUAB</b> PIN <b>F3250 UPN</b> EXT. <b>EXTFU</b>
<b>HEEL SHROUDS</b> GUARDAESQUINAS		<b>WELD-ON HEEL SHROUD</b> GUARDAESQUINAS <b>FS307 HS</b> ALTERNATIVE TO 69041891	Kg. 18,4 lb 40,48 A 198 7,80" B 152 5,98" C 219 8,62"	



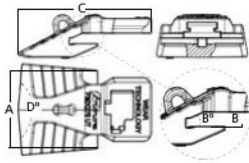
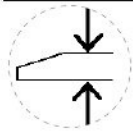

50MM

<p><b>SPADE BLADE</b> CUCHILLA DELTA</p>		<p><b>SPADE BLADE</b> CUCHILLA DELTA</p>		
<p><b>CAST CORNERS</b> CANTONERA SOLDABLE</p>		<p><b>CAST CORNER RIGHT</b> CANTONERA SOLDABLE <b>F50X175 UCCR</b> ALTERNATIVE TO 69037855, SCC50X175-RS</p>	<p>Kg. 57,5 lb 126,5 A 200 7,87" B 50 1,97" C 295 11,61"</p>	<p><b>EXTRA LONG</b> CANTONERA SOLDABLE <b>F50X175 UCCER</b> ALTERNATIVE TO 69037870, SCC50X175-RE</p>
		<p><b>CAST CORNER LEFT</b> CANTONERA SOLDABLE <b>F50X175 UCCL</b> ALTERNATIVE TO 69037854, SCC50X175-LS</p>	<p>Kg. 57,5 lb 126,5 A 200 7,87" B 50 1,97" C 295 11,61"</p>	<p><b>EXTRA LONG</b> CANTONERA SOLDABLE <b>F50X175 UCCEL</b> ALTERNATIVE TO 69037869, SCC50X175-LE</p>
<p><b>CORNER SHROUD</b> PROTECTOR ESQUINA</p>		<p><b>CORNER SHROUD RIGHT</b> PROTECTOR ESQUINA DERECHO <b>F50X235 UCR</b> ALTERNATIVE TO 69039952, SBP50X235-CR2</p>	<p>Kg. 72,6 lb 159,72 A 281 11,06" B 26,5 1,04" C 534 21,02"</p>	<p>BASE <b>FAB</b> <b>FUAB</b> PIN <b>F3250 UPN</b> EXT. <b>EXTFU</b></p>
		<p><b>CORNER SHROUD</b> PROTECTOR ESQUINA IZQUIERDO <b>F50X235 UCL</b> ALTERNATIVE TO 69039951, SBP50X235-CL2</p>	<p>Kg. 72,6 lb 159,72 A 281 11,06" B 26,5 1,04" C 534 21,02"</p>	<p>BASE <b>FAB</b> <b>FUAB</b> PIN <b>F3250 UPN</b> EXT. <b>EXTFU</b></p>
		<p><b>3/4 CORNER SHROUD RIGHT</b> PROTECTOR ESQUINA 3/4 DCHO. <b>F50X235 UCRH</b> ALTERNATIVE TO 69039954, SBP50X235-CRH2</p>	<p>Kg. 63,14 lb 138,91 A 281 11,06" B 26,5 1,04" C 480 18,90"</p>	<p>BASE <b>FAB</b> <b>FUAB</b> PIN <b>F3250 UPN</b> EXT. <b>EXTFU</b></p>
		<p><b>3/4 CORNER SHROUD LEFT</b> PROTECTOR ESQUINA 3/4 IZQ. <b>F50X235 UCLH</b> ALTERNATIVE TO 69039953, SBP50X235-CLH2</p>	<p>Kg. 63,14 lb 138,91 A 281 11,06" B 26,5 1,04" C 480 18,90"</p>	<p>BASE <b>FAB</b> <b>FUAB</b> PIN <b>F3250 UPN</b> EXT. <b>EXTFU</b></p>
<p><b>TRANSITION SHROUD</b> PROTECTOR TRANSICIÓN</p>		<p><b>TRANSITION SHROUD</b> PROTECTOR TRANSICIÓN <b>F50X288 UT</b> ALTERNATIVE TO 69039950, SBP50X288-T2</p>	<p>Kg. 59,0 lb 129,8 A 288 11,34" B 51,5 2,03" C 497 19,57"</p>	<p>BASE <b>FAB</b> <b>FUAB</b> PIN <b>F3250 UPN</b> EXT. <b>EXTFU</b></p>
<p><b>STRAIGHT SHROUD</b> PROTECTOR RECTO</p>		<p><b>STRAIGHT SHROUD</b> PROTECTOR RECTO <b>F50X290 US</b> ALTERNATIVE TO 69039947, SBP50X290-S2</p>	<p>Kg. 59,3 lb 130,46 A 290 11,42" B 51,5 2,03" C 497 19,57"</p>	<p>BASE <b>FAB</b> <b>FUAB</b> PIN <b>F3250 UPN</b> EXT. <b>EXTFU</b></p>
		<p><b>STRAIGHT SHROUD</b> PROTECTOR RECTO <b>F50X330 US</b> ALTERNATIVE TO 69039948, SBP50X330-S2</p>	<p>Kg. 65,9 lb 144,98 A 330 12,99" B 51,5 2,03" C 497 19,57"</p>	<p>BASE <b>FAB</b> <b>FUAB</b> PIN <b>F3250 UPN</b> EXT. <b>EXTFU</b></p>
		<p><b>STRAIGHT SHROUD</b> PROTECTOR RECTO <b>F50X420 US</b> ALTERNATIVE TO 69039949, SBP50X420-S2</p>	<p>Kg. 81 lb 178,2 A 420 16,54" B 51,5 2,03" C 497 19,57"</p>	<p>BASE <b>FAB</b> <b>FUAB</b> PIN <b>F3250 UPN</b> EXT. <b>EXTFU</b></p>
<p><b>HEEL SHROUDS</b> GUARDAESQUINAS</p>		<p><b>WELD-ON HEEL SHROUD</b> GUARDAESQUINAS <b>FS517 HS</b> ALTERNATIVE TO 69040888</p>	<p>Kg. 30,4 lb 66,88 A 202 7,95" B 162 6,38" C 297 11,69"</p>	

LHD MINER

Lip Shrouds STRAIGHT Protectores Cuchilla RECTOS

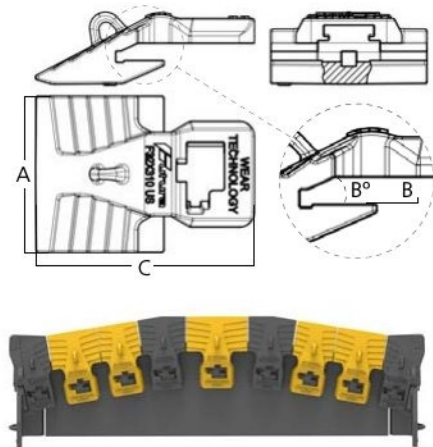

mm.		C	B°	↓ ↑	Kg	REF	ALTERNATIVE TO	BASE	PIN	TOOL	BLADE
A	B										
250 9,8"	33,50 1,3"	434 17,1"	25°	32 1,3"	34,80 76,72	<b>F32X250 US</b>	69039967, SBP32X250-S2	FAB, FUAB	F3250 UPN	EXTFU	
310 12,2"	33,50 1,3"	434 17,1"	25°	32 1,3"	41,10 90,61	<b>F32X310 US</b>	69039968, SBP32X310-S2	FAB, FUAB	F3250 UPN	EXTFU	<b>32</b>
380 15,0"	33,50 1,3"	434 17,1"	25°	32 1,3"	47,90 105,60	<b>F32X380 US</b>	69039969, SBP32X380-S2	FAB, FUAB	F3250 UPN	EXTFU	
290 11,4"	51,50 2,0"	497 19,6"	25°	50 2,0"	59,30 130,73	<b>F50X290 US</b>	69039947, SBP50X290-S2	FAB, FUAB	F3250 UPN	EXTFU	
330 13,0"	51,50 2,0"	497 19,6"	25°	50 2,0"	65,90 145,28	<b>F50X330 US</b>	69039948, SBP50X330-S2	FAB, FUAB	F3250 UPN	EXTFU	<b>55</b>
420 16,5"	51,50 2,0"	497 19,6"	25°	50 2,0"	81,00 178,57	<b>F50X420 US</b>	69039949, SBP50X420-S2	FAB, FUAB	F3250 UPN	EXTFU	

Lip Shrouds TRANSITION Protectores Cuchilla de TRANSICIÓN

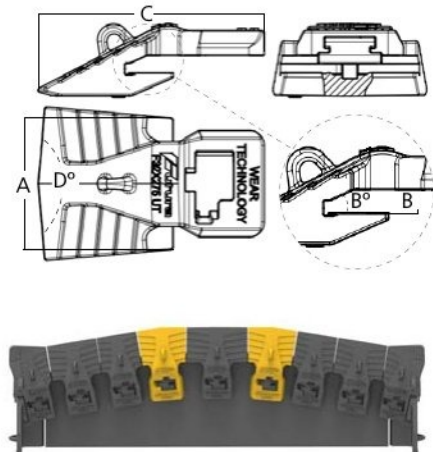

mm.		C	B°	D°	↓ ↑	Kg	REF	ALTERNATIVE TO	BASE	PIN	TOOL	BLADE
A	B											
275 10,8"	33,50 1,3"	445 17,5"	25°	170°	32 1,3"	38,50 84,88	<b>F32X275 UT</b>	69039970, SBP32X275-T2	FAB, FUAB	F3250 UPN	EXTFU	<b>32</b>
288 11,3"	51,50 2,0"	497 19,6"	25°	170°	50 2,0"	59,00 130,07	<b>F50X288 UT</b>	69039950, SBP50X288-T2	FAB, FUAB	F3250 UPN	EXTFU	<b>55</b>

Lip Shrouds CORNER Protectores Cuchilla ESQUINEROS

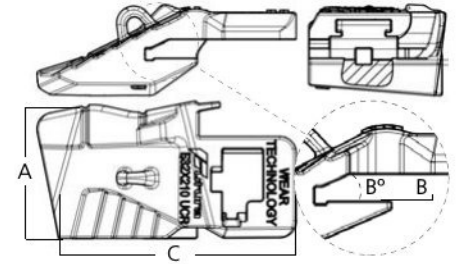

mm.						REF	ALTERNATIVE TO	BASE	PIN	TOOL	BLADE
A	B	C	B°								
243 9,6"	18,00 0,7"	472 18,6"	25°	16 0,6"	41,40 91,27	<b>F32X210 UCL</b>	69039971, SBP32X210-CL2	FAB, FUAB	F3250 UPN	EXTFU	<b>32</b>
243 9,6"	18,00 0,7"	472 18,6"	25°	16 0,6"	41,40 91,27	<b>F32X210 UCR</b>	69039972, SBP32X210-CR2	FAB, FUAB	F3250 UPN	EXTFU	
243 9,6"	18,00 0,7"	432 17,0"	25°	16 0,6"	32,90 72,53	<b>F32X210 UCLH</b>	69042488, SBP32X210-CLH2	FAB, FUAB	F3250 UPN	EXTFU	
243 9,6"	18,00 0,7"	432 17,0"	25°	16 0,6"	32,90 72,53	<b>F32X210 UCRH</b>	69042489, SBP32X210-CRH2	FAB, FUAB	F3250 UPN	EXTFU	
281 11,1"	26,50 1,0"	534 21,0"	25°	25 1,0"	72,60 160,05	<b>F50X235 UCL</b>	69039951, SBP50X235-CL2	FAB, FUAB	F3250 UPN	EXTFU	<b>55</b>
281 11,1"	26,50 1,0"	534 21,0"	25°	25 1,0"	71,80 158,29	<b>F50X235 UCR</b>	69039952, SBP50X235-CR2	FAB, FUAB	F3250 UPN	EXTFU	
281 11,1"	26,50 1,0"	480 18,9"	25°	25 1,0"	63,14 139,20	<b>F50X235 UCLH</b>	69039954, SBP50X235-CRH2	FAB, FUAB	F3250 UPN	EXTFU	
281 11,1"	26,50 1,0"	480 18,9"	25°	25 1,0"	63,14 139,20	<b>F50X235 UCRH</b>	69039953, SBP50X235-CLH2	FAB, FUAB	F3250 UPN	EXTFU	

UCL UCR

3/4 SHROUD  
 UCLH UCRH

CORNERS ARE SHORTER TO HELP MAINTAIN BUCKET PROFILE WHEN THE REST OF SHROUDS ARE WORN

ESTOS PROTECTORES SON MÁS CORTOS Y AYUDAN A MANTENER EL PERFIL DEL CAZO Y PROLONGAR LA VIDA DEL MONTAJE A CUANDO EL RESTO DE PROTECTORES ESTÁ DESGASTADO



LHD MINER

Weld-On Heel Shroud Protector Esquinero Soldable

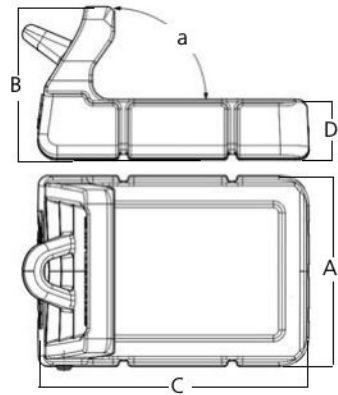
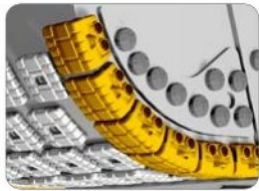

Compatible SANDVIK®

A	in	B	in	C	in	D	in	a°		Lb	SHROUD	Cross Ref
198	7,80"	152	5,98"	219	8,62"	50	1,97"	90°	18,4	40	<b>FS307 HS</b>	69041891
202	7,95"	162	6,38"	297	11,69"	64	2,52"	90°	30,4	67	<b>FS517 HS</b>	69040888

Cast CORNERS Protectores ESQUINEROS

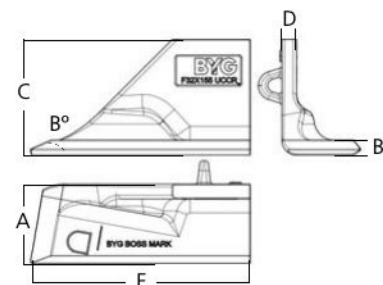

		mm.							REF	ALTERNATIVE TO	BLADE
A	B	C	D	E	B°						
171	32	250	32	476	25°	32	36,30	<b>F32X155 UCCL</b>	69039973	<b>32</b>	
6,7"	1,3"	9,8"	1,3"	18,7"		1,3"	80,03		SCC32X155-LS		
171	32	250	32	476	25°	32	36,30	<b>F32X155 UCCR</b>	69039974,	<b>32</b>	
6,7"	1,3"	9,8"	1,3"	18,7"		1,3"	80,03		SCC32X155-RS		
200	50	295	50	471	25°	50	57,50	<b>F50X175 UCCL</b>	69037854,	<b>55</b>	
7,9"	2,0"	11,6"	2,0"	18,5"		2,0"	126,76		SCC50X175-LS		
200	50	295	50	471	25°	50	57,50	<b>F50X175 UCCR</b>	69037855,	<b>55</b>	
7,9"	2,0"	11,6"	2,0"	18,5"		2,0"	126,76		SCC50X175-RS		
200	50	295	50	539	25°	50	69,00	<b>F50X175 UCCEL</b>	69037869,	<b>55</b>	
7,9"	2,0"	11,6"	2,0"	21,2"		2,0"	152,12		SCC50X175-LE		
200	50	295	50	539	25°	50	69,00	<b>F50X175 UCCEER</b>	69037870,	<b>55</b>	
7,9"	2,0"	11,6"	2,0"	21,2"		2,0"	152,12		SCC50X175-RE		

LHD MINER

**Lip Shrouds BASE** BASE para Protector

mm.				
A	B	C		REF
86	32	90	0,80	<b>FAB</b>
3,39"	1,26"	3,54"	1,76	

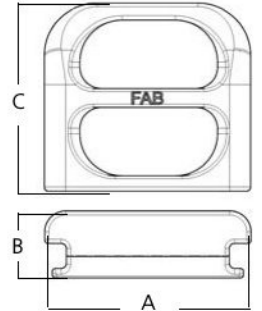
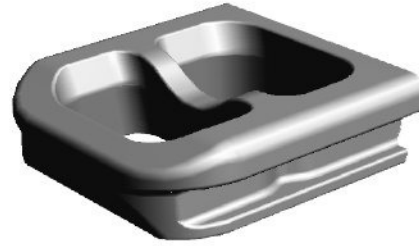

**ADAPTER for Sandvik Base** Adaptador para bases Sandvik

mm.				
A	B	C		REF
86	32	90	0,60	<b>FUAB</b>
3,39"	1,26"	3,54"	1,32	

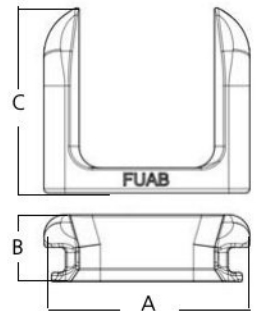

EXISTING  
SANDVIK  
BASE

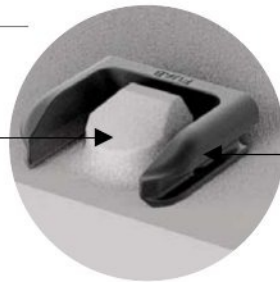

FUTURA  
FUAB  
ADAPTER

**Lip Shroud PIN** PASADOR para Protector de Cuchilla

mm.				
A	B	C		REF
127	46	121	2,29	<b>F3250 UPN</b>
5,00"	1,81"	4,76"	5,05	

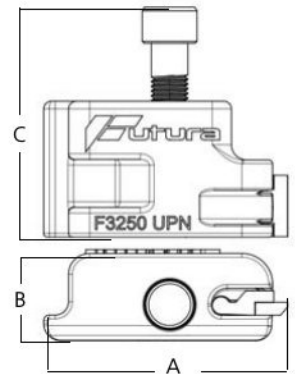

**EXTFU Pin Extraction TOOL** HERRAMIENTA Extractora

**EXTFU**  
EXTRACTION  
TOOL

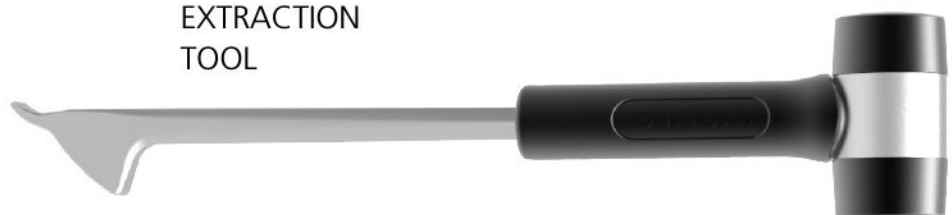

## LHD MINER

**LHD customized lips** Cuchillas LHD a medida

**Customized LHD lips  
for all underground  
mining machines**

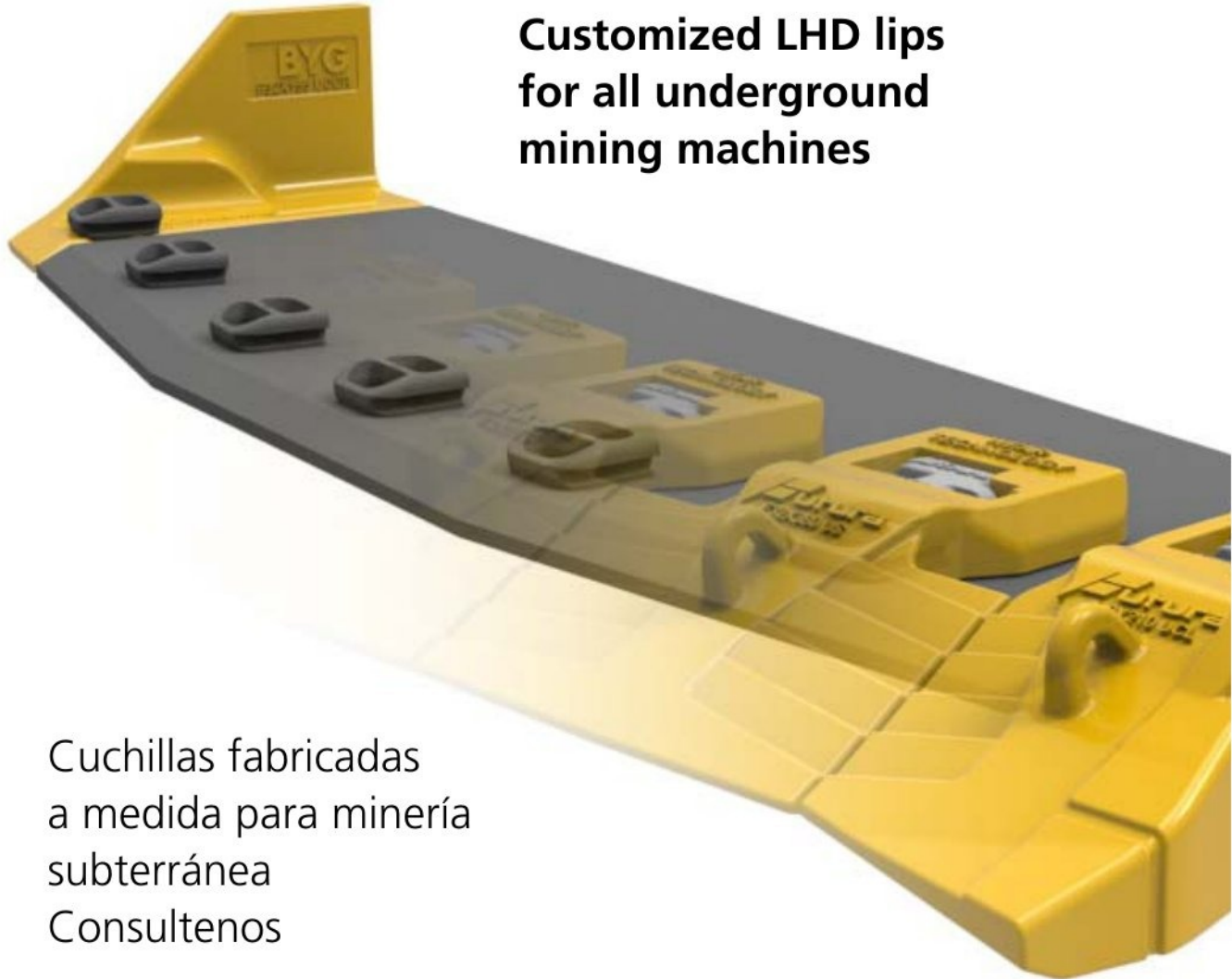

Cuchillas fabricadas  
a medida para minería  
subterránea  
Consúltenos